



Deluxe Extra Tall Walk Thru Gate with Alarm

GMI, 2671 Owingsville Rd, Mt. Sterling KY 40353
1-877-242-8392 www.gmigates.com

Thank you for purchasing the Pet Shield Deluxe Extra Tall Walk Thru Gate with Alarm!

This product is manufactured by GMI

1-877-242-8392

If you have any questions regarding this product,
Contact:

GMI

2671 Owingsville Rd

Mt. Sterling, KY 40353 (USA) 1-877-242-8392

Important:

- Gate must be installed in a structurally sound opening. Ensure mounting surface (wall, door, frame, stair post etc.) is strong, rigid and has an even surface.
- **If gate is used at top of stairs, it must be installed using permanent mounting hardware (see parts N in Parts List Page)**

When used for children follow warnings below.



WARNING

- To prevent serious injury or death, securely install and use gate according to instructions.
- Recommended for Children ages 6 to 24 months.
- Never use with a child able to climb over or dislodge the gate.
- Never leave child unattended.
- Check the stability of the gate and tighten all hardware and mountings regularly.
- Do not use if any part of the gate is broken or missing.
- Never allow a child to climb or swing on gate.
- Use only with the locking/latching mechanism securely engaged.
- Never hang or tie toys etc. to any part of the gate.
- Never climb over the gate.

Cleaning

To clean the gate, sponge with mild soap and cold water.



(A) Gate

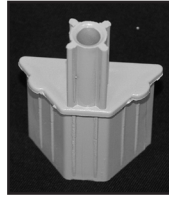

(B) Bottom for Extensions Inserts (2x)



(C) Bottom Inserts (2x)

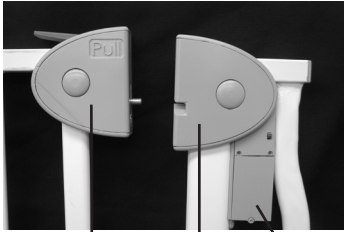

(D) Moveable Latch Housing

(E) Fixed Latch Housing

(F) Battery Compartment

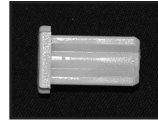

(G) Plug (4x)

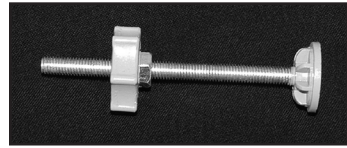

(H) Mounting Width Adjustment Screw (4x)



(I) 39" Width Extenders (x2)



(K) 42" Width Extenders (x1)



(J) Wall Template for permanent hardware mounting



(N) Permanent Mounting Hardware (x4)

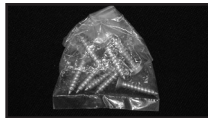

(L) Phillips Head Screws (8x)

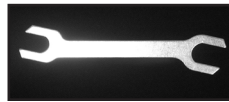

(M) Wrench (4x) Latch Gap Tester

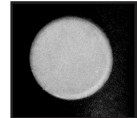

(O) Rubber Pad

Do not discard permanent mounting hardware as it may be needed later if you move your gate or after your pet gets larger.

If parts are missing or if you have any questions about our product, please call us before beginning the assembly process.

The gate is packed with a plastic tie around the vertical slats. *figure 1*. Cut the plastic tie to relieve pressure. Caution: When tie is cut, gate will spring open.

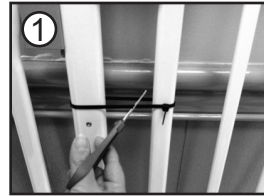

Your gate is able to be used as a pressure gate or wall mounted gate. If the gate is to be used at the top of stairs it must be permanently mounted. Instructions for permanent mounting are on pg. 10. The instructions below are for pressure mounting.

Your gate can be used without extenders, if the door opening is less than 34 inches. If the door opening is greater than 34 in., go to the instructions on pg.9 for information on adding extenders.

NOTE: For larger pets or top of stairs, use permanent mounting hardware - See page 10.

Installation instructions for openings 31" to 34"

Slip square plastic plug (G) on adjustment screw (H). Insert the Top Width Adjustment screw into the openings at the **TOP** of both ends of your gate. *figure 2*

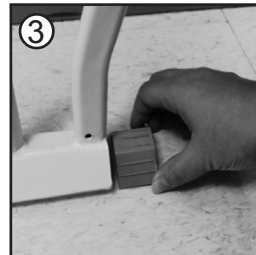
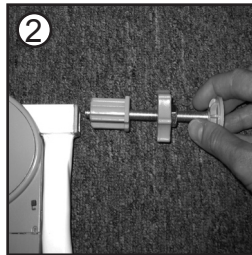

Insert the **BOTTOM** inserts (C) into the opening on both ends of the bottom of your gate treddle. *figure 3*

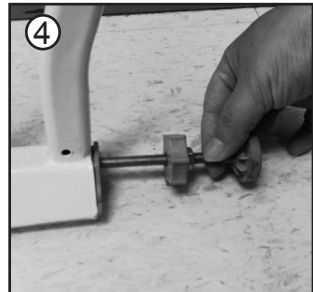

Insert the Width Adjustment Screws (H) into the bottom inserts. *figure 4*

Positioning Gate

Place the gate into the opening. Using the wrench provided adjust the Gate position by turning the wheel on the top adjustment screws until the gate top is tight in the opening. *figure 1*. **NOTE: Top adjustment screws must be adjusted first. They can only extend a maximum of approximately 1-1/2" - Do not force.**

Next adjust the bottom adjustment screws until the gate bottom is secure.

NOTE: When positioning the gate, make sure that you maintain an equal gap between the gate and the opening on both sides. *figure 2c*

As you tighten the top adjustment screws, the latching unit will slowly come together. To assure proper spacing for the gate latch pull back on the movable latch housing unit until it is extended open. *figure 2*

Continue to tighten the adjustment screws until the fully extended moveable latch housing is as close as possible to the fixed latch housing. A good rule is gap between housings is equal to thickness of adjustment of wrench. *figure 2a*. The spacing is correct when the gate swings freely, just barely missing the fixed housing. *figure 2b*

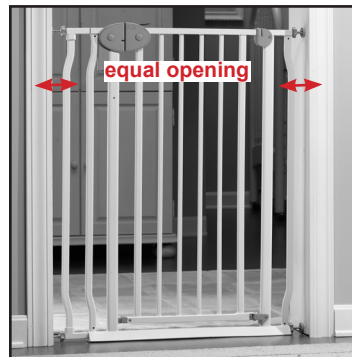
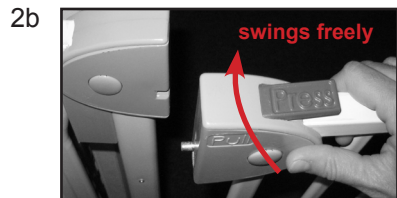
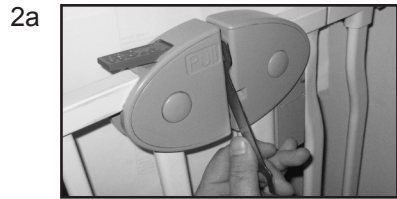
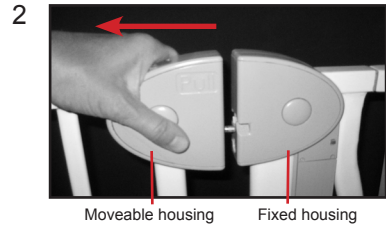
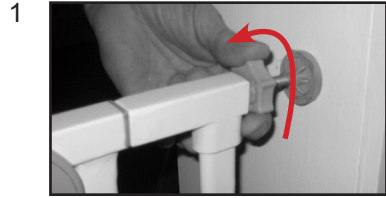

Operating Gate

To open gate: Press down on top latch (red) and pull back. The walk through portion of the gate should swing freely in both directions. The gate is spring assisted and will swing back after opening. *figure 1, 2, & 3.* Gate can be left in full open position if needed. Slowly open gate, spring action detent will hold gate in full open position. *figure 4*

NOTE: If gate seems to shake or is unstable, additional tightening may be required at one or more of the mounts. This will be particularly noticeable if the door opening is not square.

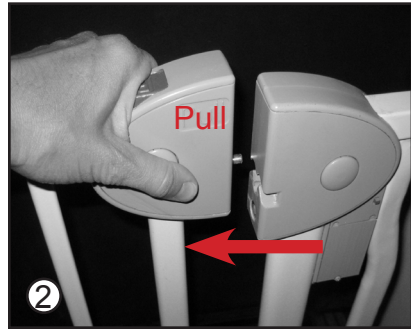
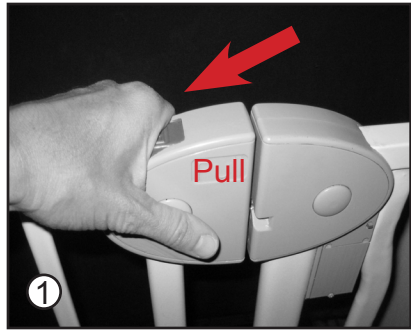

Gate Alarm

The Deluxe Extra Tall Gate comes equipped with an Alarm. When the gate is not closed properly the alarm will sound. The alarm will become increasingly louder until the gate is closed properly. If the alarm sounds after the gate is latched, re-open and re-latch.

Though we do not recommend turning off the alarm, there may be occasions you need to do so. The gate comes with a small on/off switch which is located under the fixed housing. *figure 1*

WARNING! Turn the alarm switch on when small children are present.

Installing Alarm Batteries

The Battery Compartment is located just below the latch housing and is attached with one phillips head screw. Unscrew the battery compartment door and insert two "AA" batteries.

Be sure to follow the positive and negative designations on the compartment door. Replace compartment door and tighten screw. *figure 2 & 3*

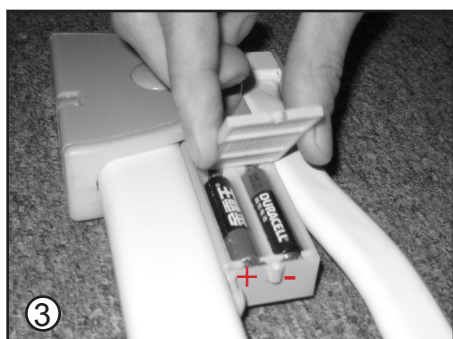
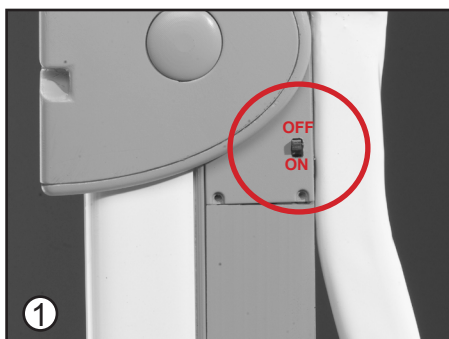

Refer to page 9 for safe battery use

Safe Battery Use

Keep batteries out of children's reach.

Batteries may leak fluids that cause a chemical burn injury or ruin your product. To avoid battery leakage:

- Do not mix different battery types.
- Do not mix old and new batteries.
- Make sure batteries are inserted correctly.
- Do not mix alkaline, standard and rechargeable batteries.

Discard leaky batteries immediately. When discarding batteries, be sure to dispose of them in proper manner according to your state and local regulations.

Installation Instructions for widths from 34-1/2" - 39" openings

If the doorway is wider than 34", you can add Width Extenders (I) on one or both sides of your gate. One extender will add 3 1/8" to the gate width. Both extenders will add 6 1/4" to the gate width.

To add one Extender to your gate, first insert one Bottom Extension Inserts (E) in the opening at the bottom of your gate. *figure 1*

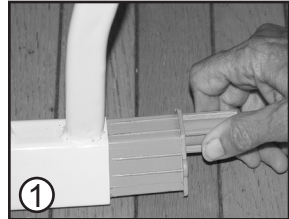

After Bottom Extension Insert is in place, assemble extension to gate. *figure 2*

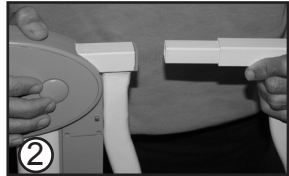

To add two extensions, stack second extender on first or you can center gate by repeating assembly steps for other side. See *figure 3 and 4*.

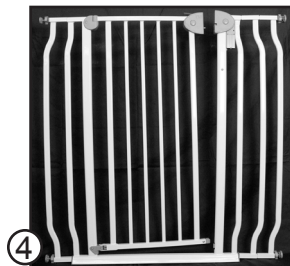
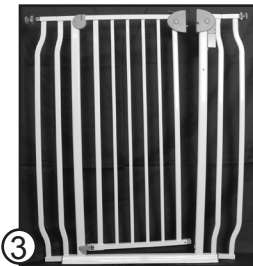

Installation Instructions for widths from 39-1/2" - 42" openings
Add the width extender (N) on one side of your gate.

Top/Bottom of Stairs Installation

For use when at top or bottom of stairs for children or for larger pets.

Do not discard permanent mounting hardware as it may be needed later if you move your gate or after your pet gets larger.

A wall mounting template (J) is provided to help you properly locate the screw holes for the gate mounting brackets.

The screws provided are for mounting directly into a wood door frame. If the frame is hardwood, it may be necessary to drill pilot holes for the screws (3/32").

If mounting to brick, drywall or other materials, you must select appropriate fasteners such as plastic anchors (not provided).

Tape the Mounting Templates vertically and completely outstretched against one of the mounting surfaces with the arrow pointing down. The bottom end will touch the floor (it may be convenient to hold the template in place with masking tape). *figure 2* Mark the 4 screw hole positions. Remove template. Repeat for the other mounting surface.

Using the Wood Screws (L) provided (or the fasteners you choose). Mount the Permanent Brackets (N) in position. *figure 3*

Once you have all four Permanent Brackets mounted, you can attach the gate. Snap the ends of the adjustment screws into the permanent wall brackets that are mounted into the doorway. *figure 4*. Tighten the adjustment screws so the gate is secure. Adjust space in latch as per pg. 6, figures 2 and 3.

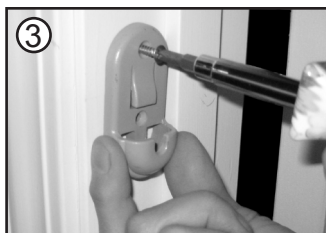
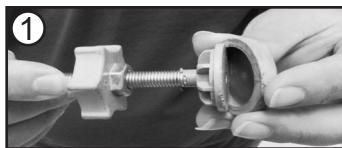

Index

Alarm Operation.....	p 8
Battery Specifications.....	p 8
Cleaning Instructions.....	p 3
Operating Gate.....	p 7
Parts List.....	p 4
Pressure Mounted Installation.....	
31" to 34" openings.....	p 5
34-1/2 to 39" openings.....	p 9
39-1/2" to 42" openings.....	p 9
Top & Bottom of Stairs Installation.....	p 10
Warnings.....	p 3



∞ That if you confess with your mouth, "Jesus is Lord," and believe in your heart that God raised him from the dead, you will be saved.
Romans 10:9 NIV Bible